

# INSTALLATION GUIDE

## Aluminum Trim System for Panel & Lap Siding



TABLE OF CONTENTS

	PAGE
Features.....	3
Installation Support .....	3
Before You Get Started .....	4
Care & Maintenance .....	4
Product Storage & Handling.....	4
Personal Protection Equipment (PPE).....	5
Tools & Accessories.....	6
Trim Info.....	7
Wall Preparation.....	8
Fastening Info.....	9
General Panel Installation Process .....	10
General Panel Window Details .....	17
General Lap Installation Process.....	19
General Lap Window Details.....	22
FAQ.....	23
Product Warranty .....	25

## Features

Superior dirt and water management, quick and easy installation with our two piece trim system, and high-quality curb appeal are hallmarks of EasyTrim Reveals® Exterior Aluminum Trim System.

- ✓ Built-In Moisture Management
- ✓ Hidden Fasteners
- ✓ Caulk-Free Connections
- ✓ Transition Panel to Plank
- ✓ Clean Window & Corner Lines
- ✓ Fastest & Easiest Install Available
- ✓ Free Samples
- ✓ Complete Two piece Trim System



### **EZ.Lock®**

Two piece trims ensure maximum edge protection and significantly speed up the installation process by providing open “tab-free” areas to quickly place fiber cement on the wall.



### **EZ.Fit&Finish™**

No sharp edges. EasyTrim Reveals® overlapping trims create smooth transitions at the corners and high traffic areas.

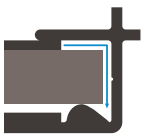

### **EZ.Bump®**

EZ.Bump® protects fiber cement cut edges and building envelope.



### **EZ.Line®**

Each profile has a fastening guide called the EZ.Line® – located on the fastening flange of back plates.

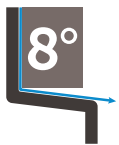

### **EZ.Slope®**

EasyTrim Reveals® 8° sloped reveals sheds water, dirt and debris down and away from the building.



### **ColorMatch®**

EasyTrim Reveals® are only limited by your imagination, offer a wide-range of standard color options, and can easily accommodate custom colors.

## Installation Support

Our Installation Support Team is available for additional instruction, to ensure that your project is executed not only correctly, but efficiently – saving you time and money.

Please contact us at 1-877-973-8746 to reach our dedicated Installation Support Team.



Connect with a representative today

## Before You Get Started

Follow your local building codes and project specifications.

Wear appropriate safety equipment and ensure a safe work environment.

Material will be received on an pallet (Figure 4.1). Pallet size will vary. All products will be labeled separately.

Inspect all material for damage, defect, correct color, correct color consistency, and correct trim specification:

Verify your labels to ensure you have all the correct components for your order, each bag is labeled.

All one piece profiles are wrapped and labeled on the bag tag for type and finish.

All two piece profiles (top caps and back plates) are bagged individually and wrapped together. The labels for two piece profiles are identified with joint labels showing both components. Verify what is in the bag.

Ensure that you have ALL the correct tools in safe working order.

All trims are 10' in length and are made from solid aluminum.

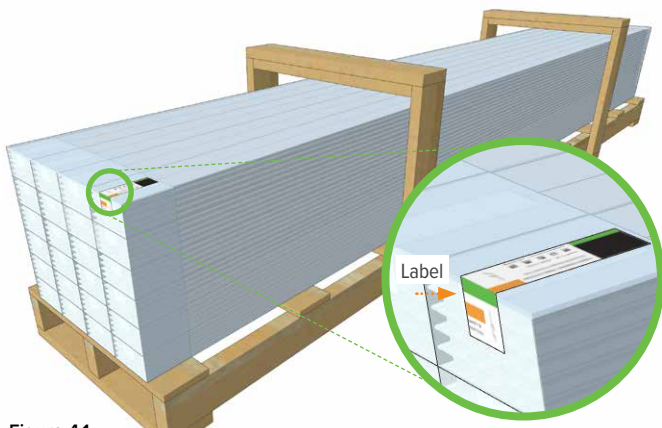

Figure 4.1

## Care & Maintenance

EasyTrim Reveals® Trim Systems are designed to be low maintenance and require basic annual wash down maintenance after installation.

## Storage & Handling

### Storage

Trims may be stored outdoors; moisture and temperature will not damage aluminum trims.

Don't stack other material on top of trims.

### Handling

To avoid any unnecessary damage, do not slide or drag trims on the ground or against any abrasive surface.



### REMINDER

To ensure product performance, follow all installation instructions as well as all applicable building codes. Failure to do so may void the product warranty.



## Personal Protection Equipment (PPE)

We recommend the appropriate use and application of the following PPE during installation.

1. Steel Toe Boots
2. Cut Resistant Gloves
3. Safety Glasses
4. Hard Hat
5. Ear Protection
6. Safety Vest
7. Fall Protection
8. Dust Mask
9. First Aid Kit



### WARNING

Consult your local safety codes and regulations.

## Tools & Accessories

The following general tools will also be required for installation:

1. Mitre saw + **non-ferrous metal cutting blade**
2. Track saw with fiber cement cutting blade
3. Impact driver / drill
4. Siding nailer
5. Air compressor / air hoses
6. HammerBlock® (available from EasyTrim®)
7. Tape measure
8. Permanent marker & carpenter's pencil
9. Utility knife
10. Extension cords
11. 2' 4' 8' levels
12. Chalk line
13. Metal drill bit
14. Phillips driver bit
15. Torx driver bit
16. Mini pry bar / glazing bar
17. Deadblow hammer or rubber mallet
18. Tin snips
19. Framing square
20. Hammer
21. Needle nose pliers
22. Cut table with styrofoam
23. Pocket laser level
24. A circular saw can be used without a track saw guide rail, but will be less efficient for cutting the panels



# Trim Info

## How to choose a trim

\*Two piece trims are recommended and provide the most value.

There are three main considerations when choosing a trim. Review the following to help choose the best trims for your project.

### Option 1\*

Two piece trims reduce installation times (Figure 7.1).

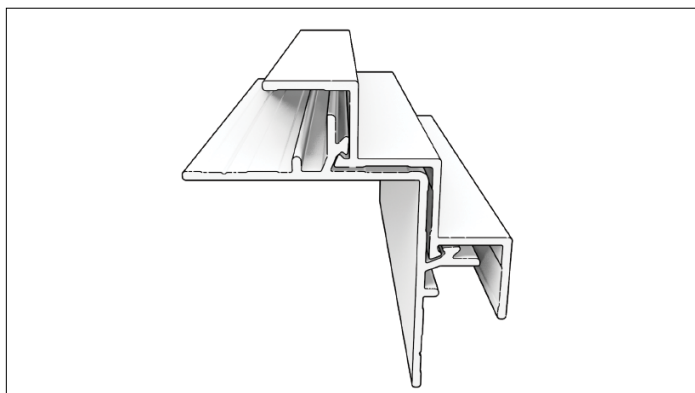

Figure 7.1

### Option 2

One piece trims are the most cost effective (Figure 7.2).

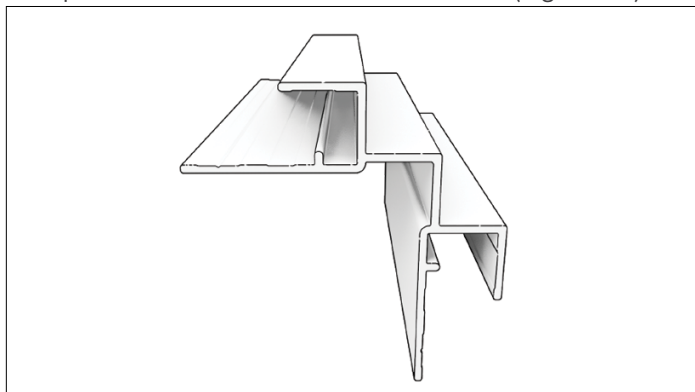

Figure 7.2

## AESTHETIC

There are multiple design options for the same application. Trim selection will achieve different aesthetics for your project (i.e. outside corners, jambs and material transitions, horizontal trims etc.).

An aesthetic choice can impact installation time and cost. For example, in a window jamb there are three options for trim selection:

- a. EZ.8 is a one piece trim with a single tab.
- b. EZ.20 is a two piece trim that shows a reveal-tab.
- c. EZ.19 is a two piece trim that shows a tab-reveal-tab that matches identically to an EZ.7 and an EZ.5 to achieve a cohesive grid line.

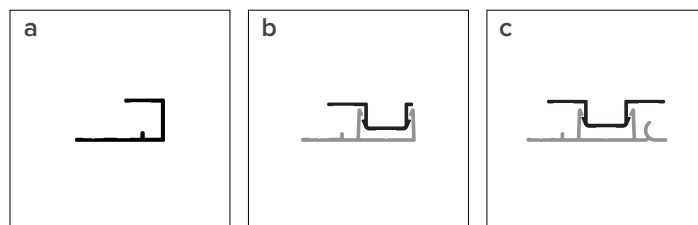

**Note:** All of our profiles are ten foot (10') lengths.



### TIP

Please consult your local sales representative to assist with trim selection.

## Wall Preparation

Follow local building codes for all primary flashing details before commencing EasyTrim Reveals® installation. EZ.28 (shown in Figure 10.1) is an extruded window drip cap flashing.



Figure 10.1

Ensure the proper air and water barrier (AWB) has been installed as per your local building code and project specifications (Figure 10.2).

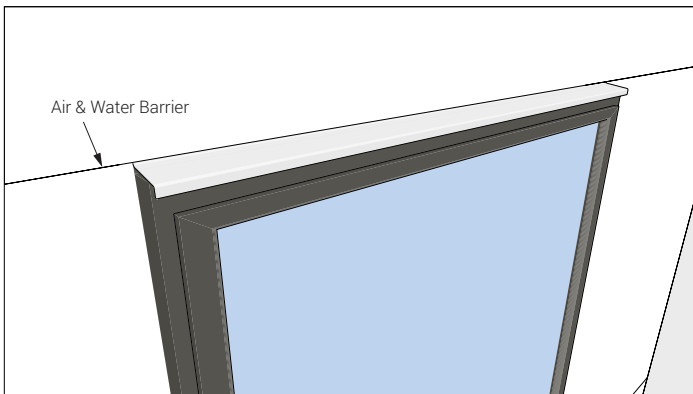

Figure 10.2

### Identify your substrate material:

- Direct to wood substrate
- Wood furring
- Metal furring (hat track / girts)
- Plastic furring strips

**Note** If you have questions about your substrate material or alternative substrate fastening scenario – please contact the Installation Support Team at 1-877-973-8746



### Using Furring Strips

When installing two piece trim profile assemblies on top of furring strips, a continuous furring strip is required to ensure proper engagement of the trims. (Figure 10.3).

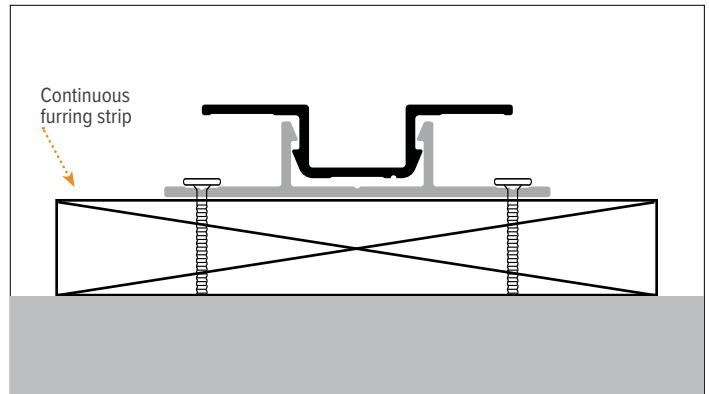

Figure 10.3



### ATTENTION

Refer to your local building codes and project specifications for AWB and primary flashing details.

## Fastening Info

### Substrate Type

#### Wood

Nails: 1 ¼" or greater (based on job requirements), hot-dipped galvanized ring-shank.

Screws: ¾" or greater (based on job requirements), self-piercing galvanized/stainless low depth head.

#### Wood Nail



#### Wood Screw

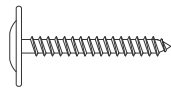

#### Metal

Screws: ¾" or greater (based on job requirements), greater self-tapping, low depth head.

#### Metal Screw

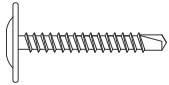

**Note** Ensure screw head depth is low enough to allow for panel to be installed so that it is not under tension. (Figure 11.1).

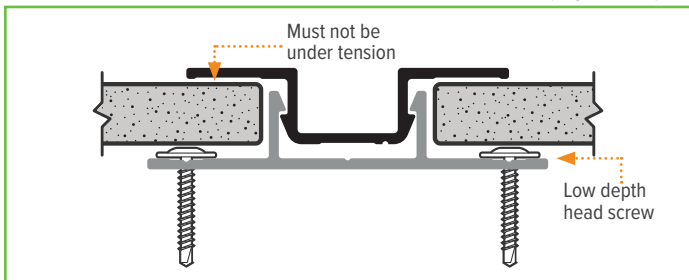

Figure 11.1

### Where to Place Fasteners

- Each profile has a fastening guide called the EZ.Line® located on the fastening flange. (Figure 11.2).

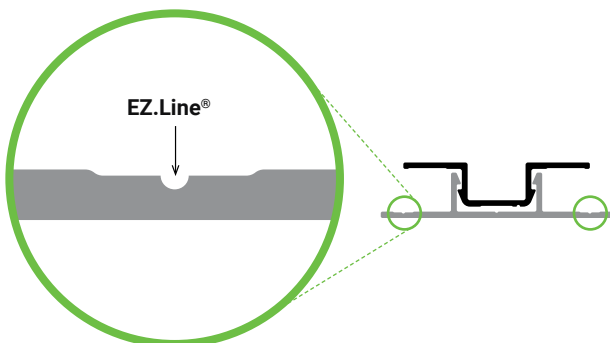

Figure 11.2 Pictured: the EZ.Line® on the EZ.7 Vertical U Panel Assembly back plate.

- Fasten at 16" on center and no further than 2" from ends.
- On any corner profile or profile with two fastening flanges, alternate the nailing patterns from one flange to the next (Figure 11.3). Avoid aligning nails to prevent pillowing or buckling of the profile, except at ends. At any end of a trim having two nailing flanges it is recommend to have a nail in each flange no further than 2".
- Fasten all vertical and horizontal trims to studs when possible.

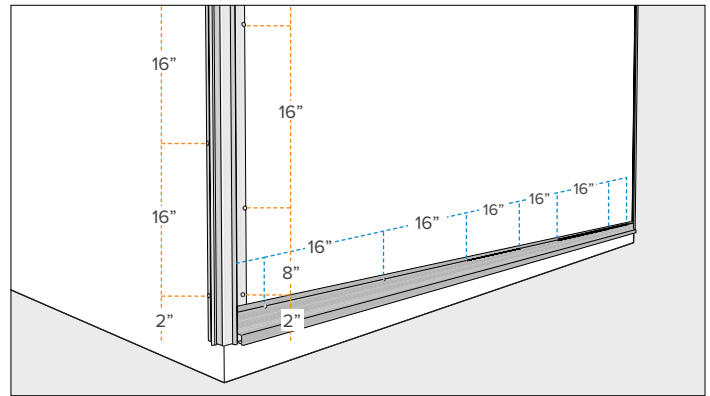

Figure 11.3

- Do not fasten two pieces of trim together (Figure 11.4).

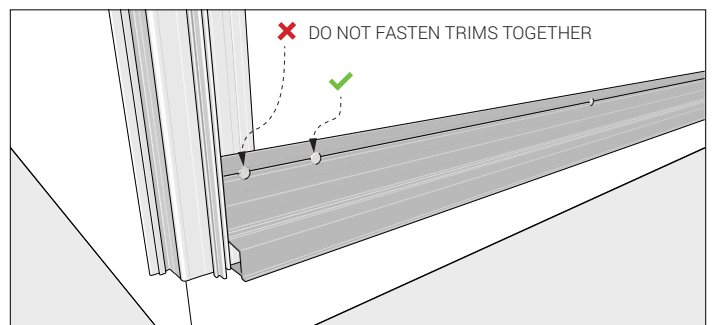

Figure 11.4

- Never fasten a panel or lap plank through a nailing flange. This could result in damaging the panel over time. (Figure 11.5).

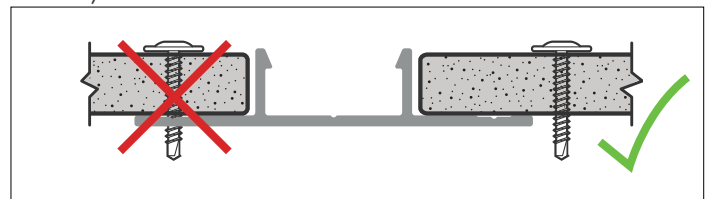

Figure 11.5



# General Panel Installation Process



## Completed Panel Installation

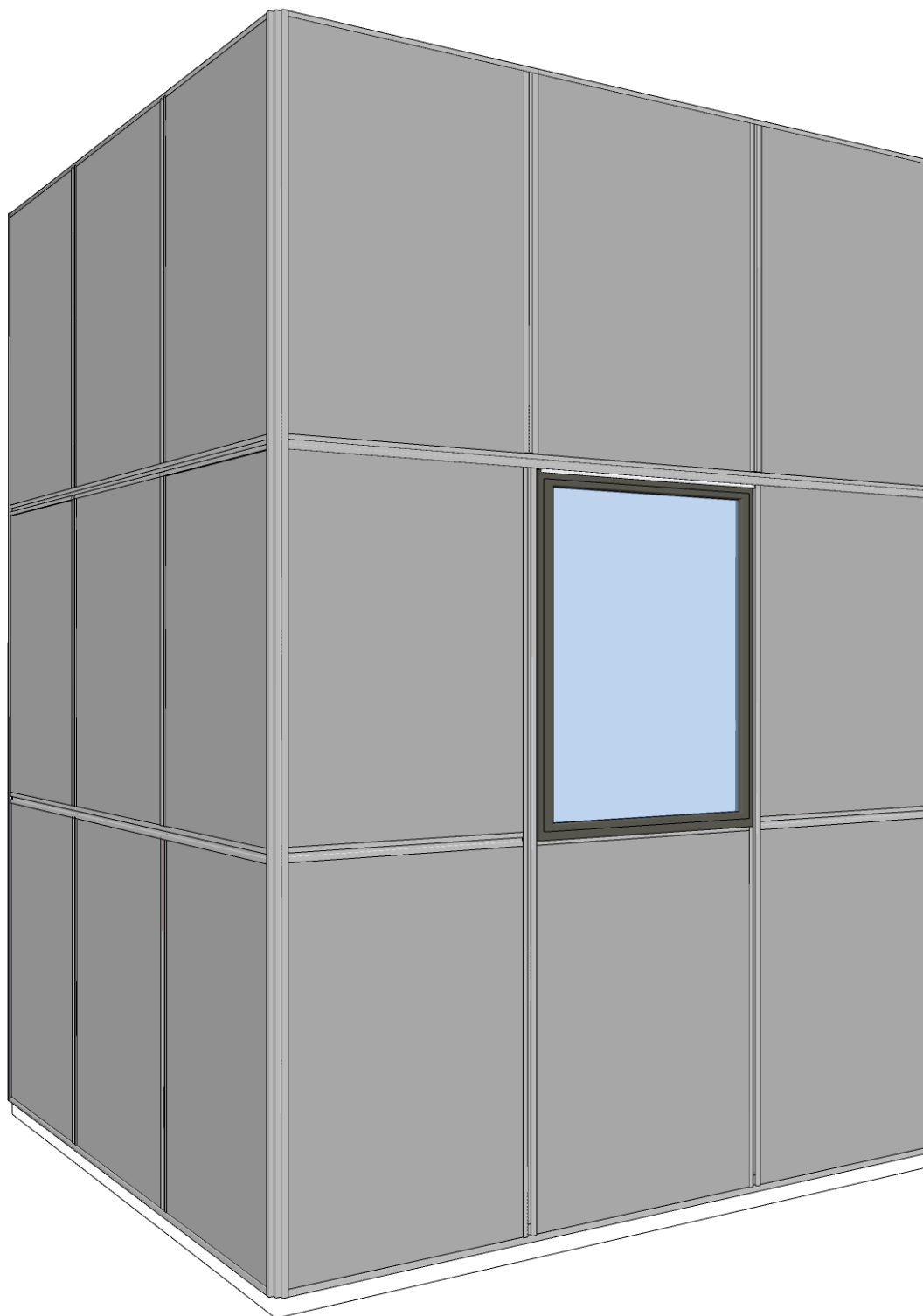

## General Panel Installation Process

1. Confirm grid line layout as per final project (approved) drawings and layout midfield grid lines to align trims to. (Figure 13.1).

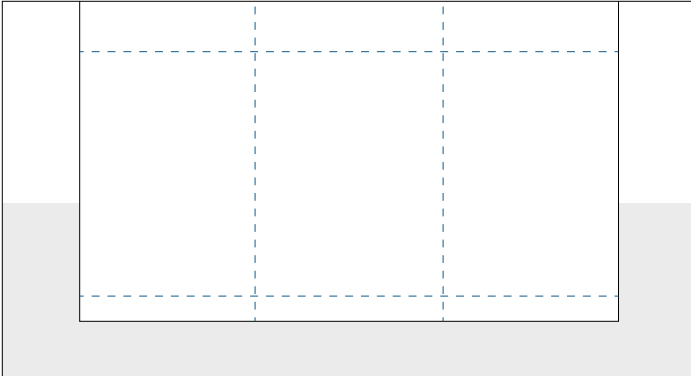

Figure 13.1

2. Place the bottom of the EZ.12 outside corner back plate at the cladding start point and fasten. (Figure 13.2) (See **Fastening Info**).

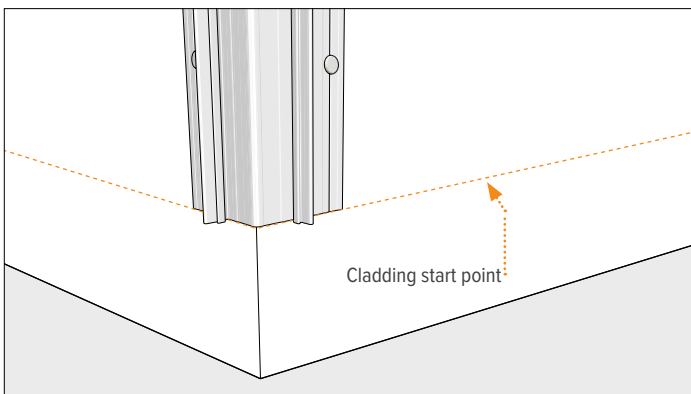

Figure 13.2

3. Place the starter trim over top of the nailing flange of the vertical outside corner leaving a 1/16" gap from the EZ.Bump®. Align the bottom edge of the horizontal trim with the bottom of the vertical outside corner. Level and fasten. (Figure 13.4).

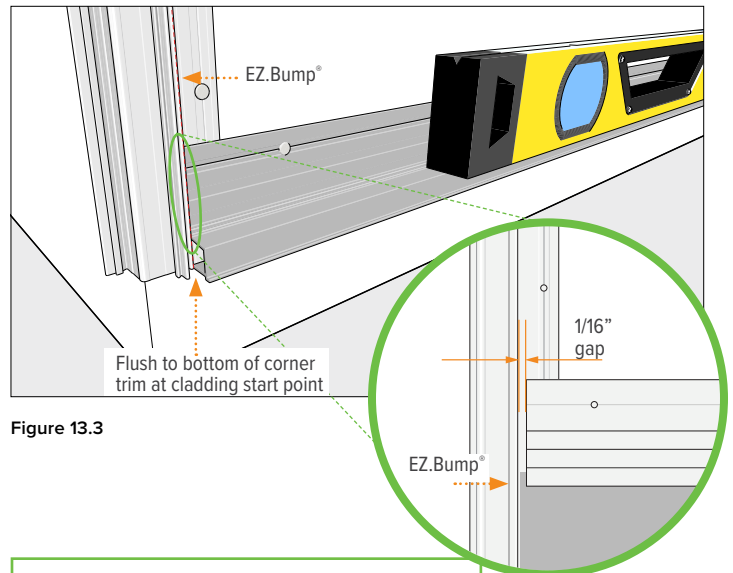
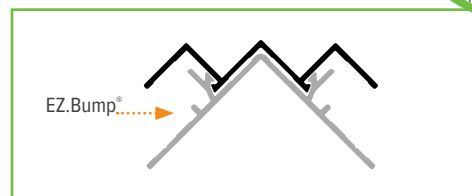

Figure 13.3



## General Panel Installation Process (Cont.)

4. Install 8" x 8" flashing (building paper) over the nailing flange of the horizontal trim (Figure 14.1). Centered behind the midfield vertical trim location (EZ.7).

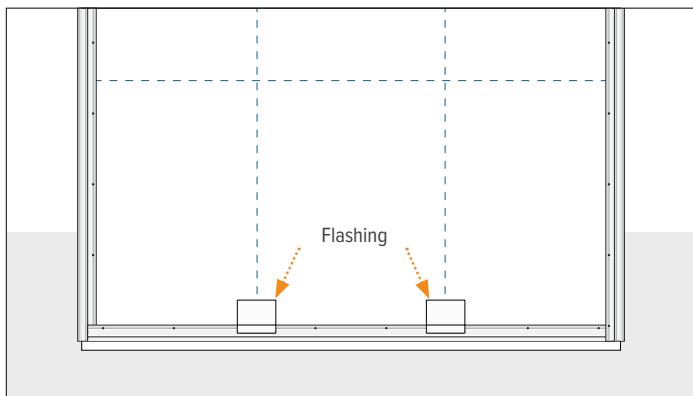

Figure 14.1

6. Make sure the EZ.7 vertical back plate never overlaps with any horizontal nailing flange (Figure 14.3 a & b).

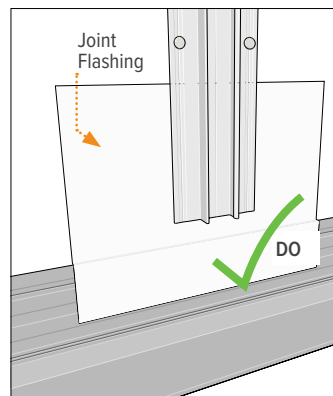

Figure 14.3 a

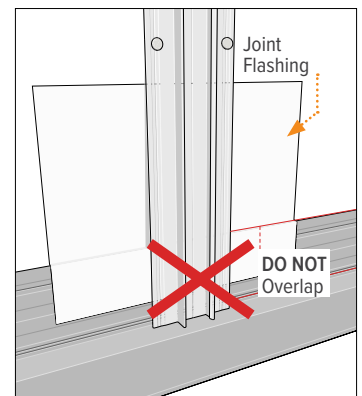

Figure 14.3 b

5. Apply the midfield EZ.7 back plate over the flashing so that the bottom is 1/4" above the horizontal trims nailing flange and the top aligns with the top of panel location and fasten in place. (Figure 14.2) (see **Fastening Info**).

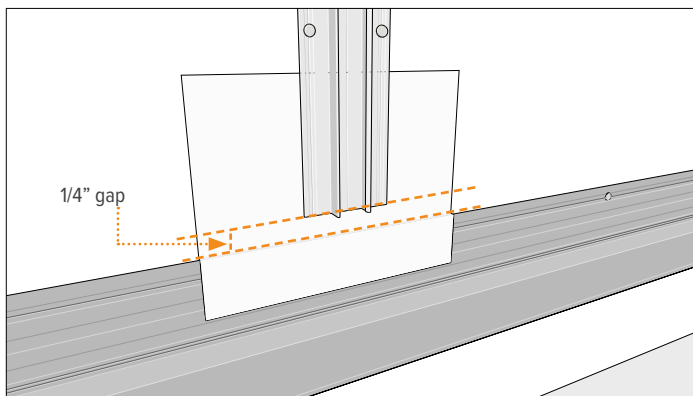

Figure 14.2

7. Plumb & fasten all the midfield vertical back plates along the same course. (Figure 14.4) (see **Fastening Info**).

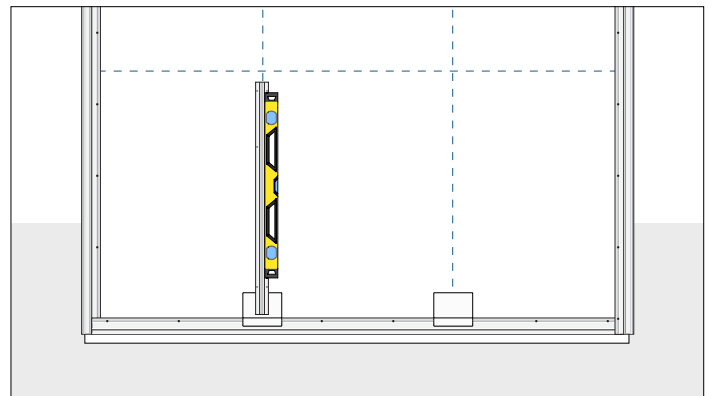

Figure 14.4



## General Panel Installation Process (Cont.)

8. To cut a panel measure horizontally between the trims and cut 1/8" less. (Figure 15.1).

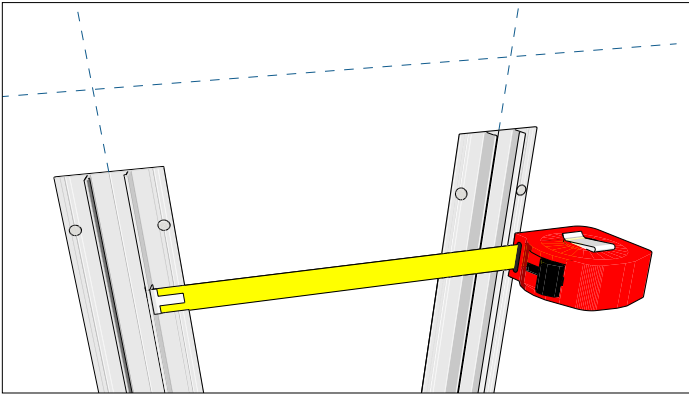

Figure 15.1

9. The vertical height of panel will be the length from the ledge of the horizontal trim to the top of panel location. (Figure 15.2).

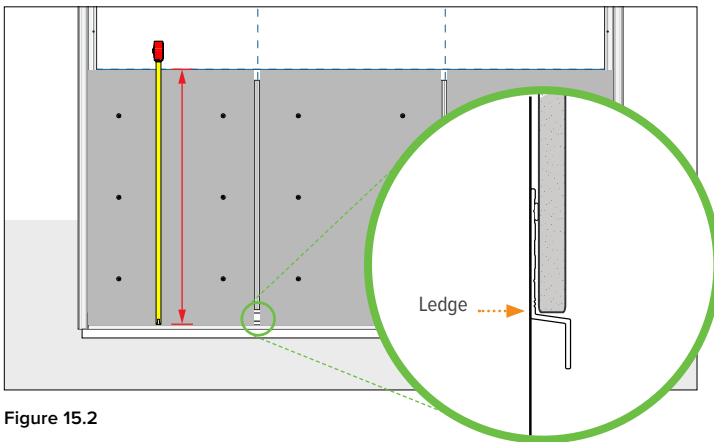

Figure 15.2

**NOTE:** Some panel manufacturers require a gap between the ledge of the horizontal and the bottom edge of the panel. Reference your panel manufacturer's install info requirements. (Example: Figure 15.3).

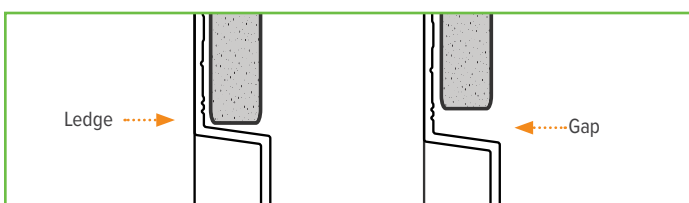

Figure 15.3

10. Fasten the panel's to the wall as per fiber cement manufacturers specifications (Figure 15.4).

**\*\*See note below**

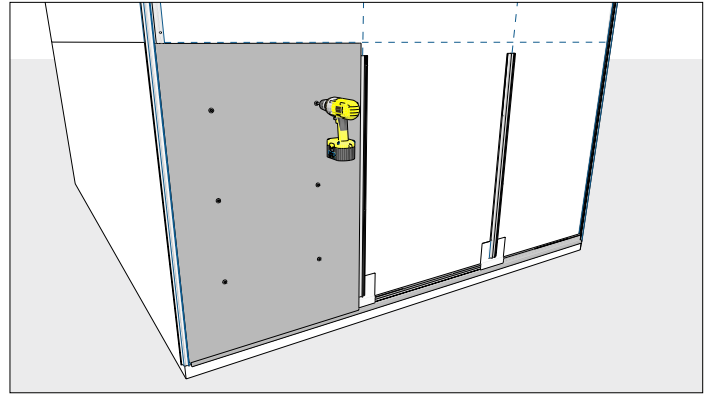

Figure 15.4

**Note :** *Never fasten a panel or lap plank through a nailing flange. This could result in damaging the panel over time. (Figure 15.5) (see Fastening Info).*

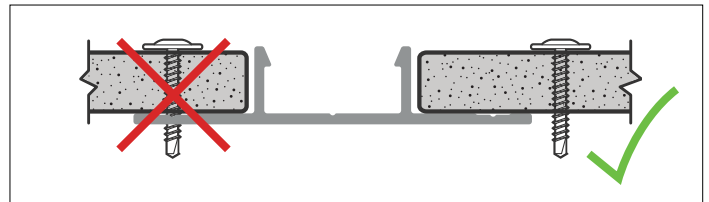

Figure 15.5

11. Measure the vertical **top cap** from the top edge of the panel to the outer edge of the horizontal trim. The bottom edge of the **top cap** needs to be cut at an 8-degree bevel to match the 8-degree slope of all horizontal profiles (Figure 15.6).

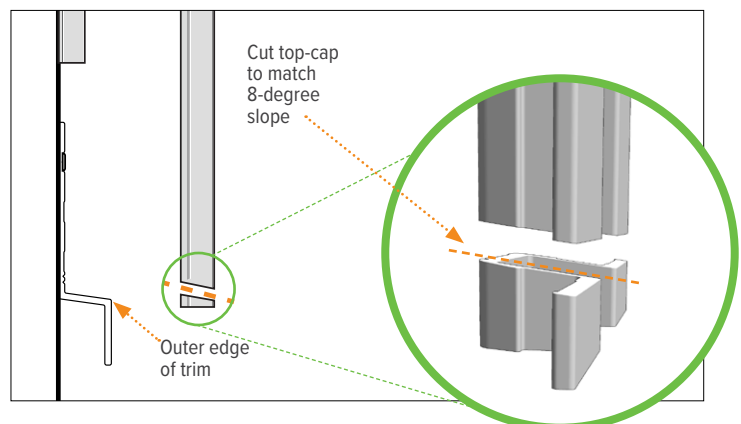

Figure 15.6

## General Panel Installation Process (Cont.)

12. Install a small dot of exterior silicone into the EZ.Lock® channel of the back plate at 24" intervals (Figure 16.1). This applies to all two piece trims.

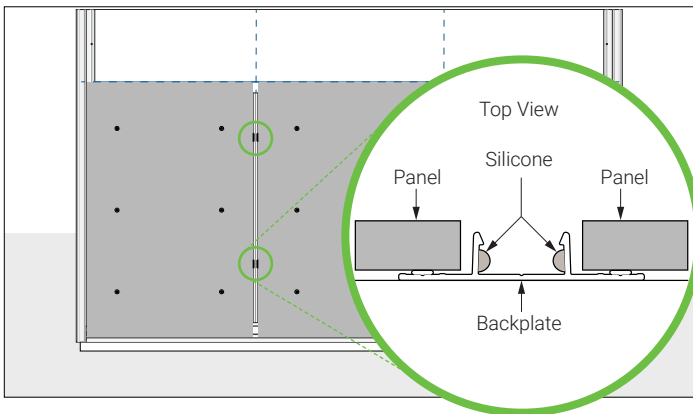

Figure 16.1

13. Align the top cap with the back plate. Place the EasyTrim® HammerBlock® in the center of the top cap. Hit the HammerBlock® in 8" to 10" increments along the length of the trim from one end to the other. (Figure 16.2).

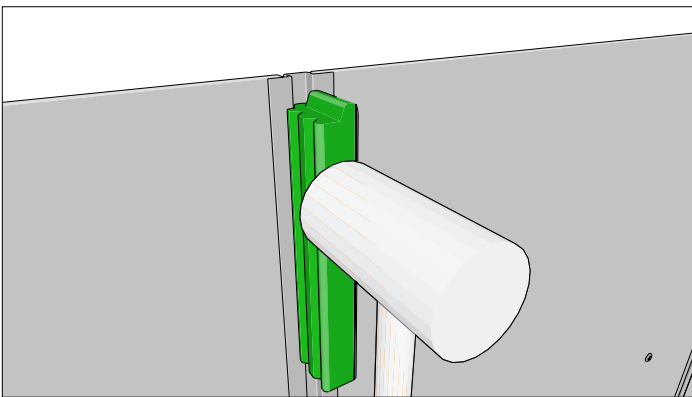

Figure 16.2

14. Install the EZ.5 midfield horizontal by overlapping the bottom tab over top of the top edge of the panel and the ends of the vertical trims. Make sure trim is level and fasten. (Figure 16.3) (See **Fastening Info**).

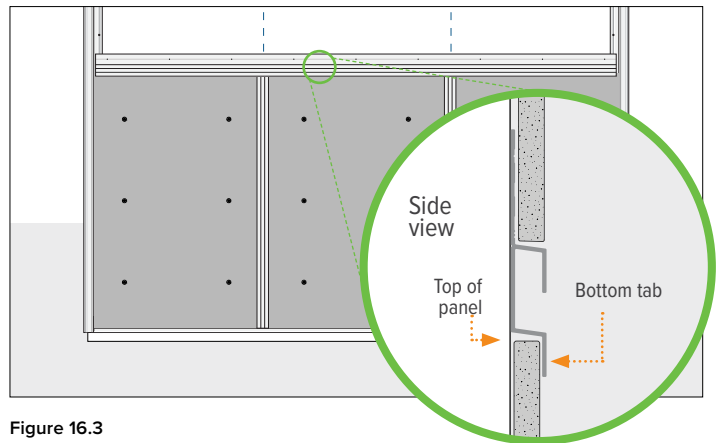

Figure 16.3

15. Leave a 1/16" gap between the end of any horizontal trim and the EZ.Bump® (Figure 16.4). Install next rows using the same install instructions as the first.

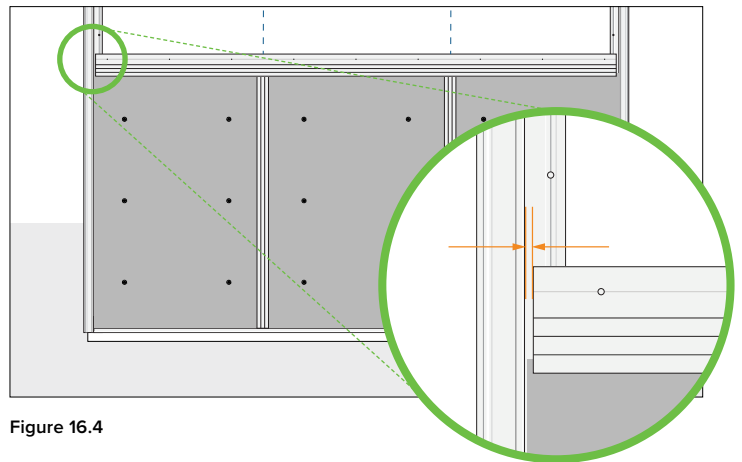

Figure 16.4



## General Panel Installation Process (Cont.)

16. At the top of the wall use a one piece or two piece J. At the ends of the horizontal J overlap the vertical trims nailing flange with a 1/16" gap from the EZ.Bump®. Keep any midfield vertical back plates away from the horizontals J trims nailing flange by 1/4". (Figure 17.1).

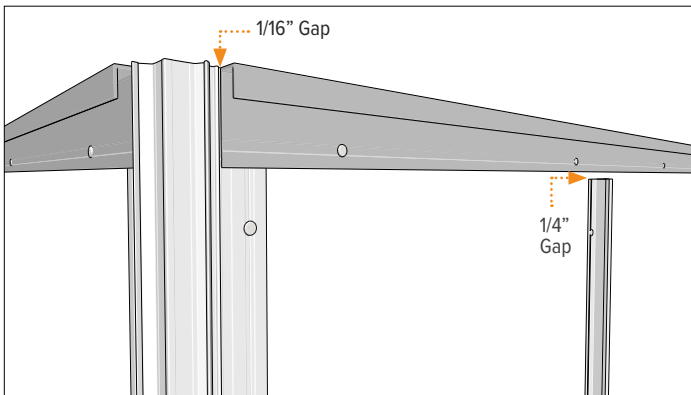

Figure 17.1

17. Install cladding on remaining sides of building following previous instructions (Figure 17.2). Corner top caps are the last trims installed.

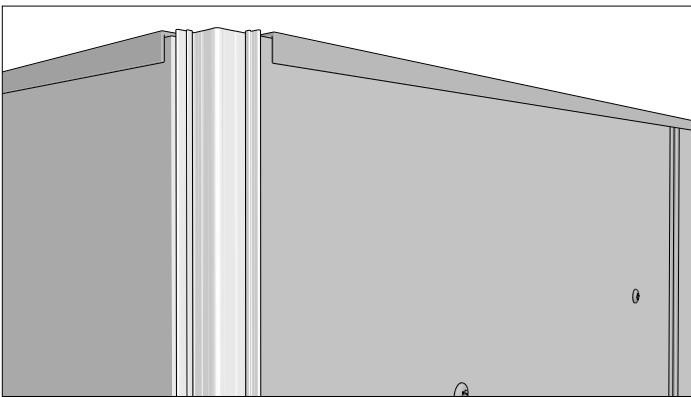

Figure 17.2

18. Align the top cap with the back plate. Place the EasyTrim® HammerBlock® in the center of the top cap. Hit the HammerBlock® in 8" to 10" increments along the length of the trim from one end to the other. (Figure 17.3).

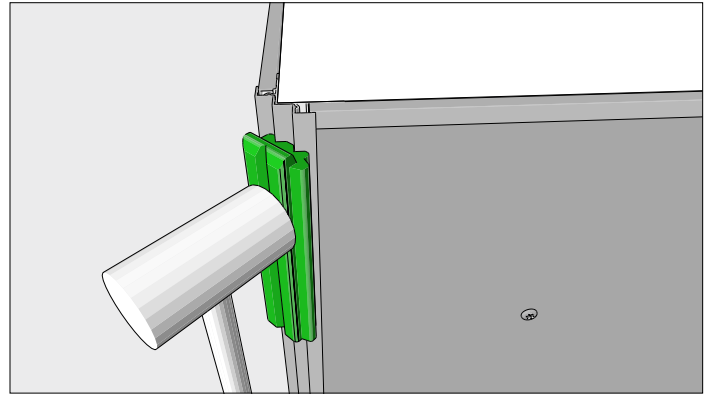

Figure 17.3



### INSTALLATION TIP

Corner top caps in most cases are the last trims to install. This is specific to two piece assemblies.



## Basic Panel Window Details

**NOTE:** The following instruction is for window and door trim installation with a typical design layout. When installing around a door only use instructions for jambs and head details.

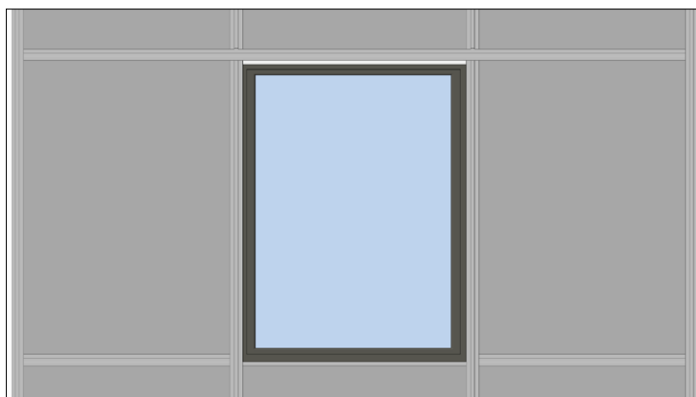

Figure 18.1

1. Place EZ.8 window sill trim at sill extending it 3/8" past both sides of window frame and fasten. (Figure 18.2) (see **Fastening Info**).

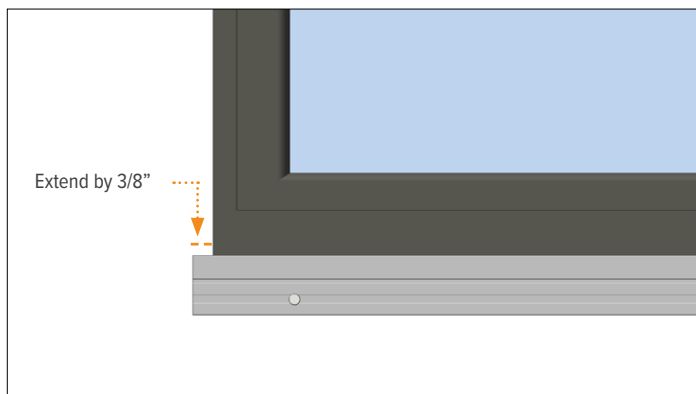

Figure 18.2

2. Apply EZ.19 back plate to both window jambs with the silicone channel butting to the window frame. Align the bottom of the back plate to the bottom edge of the window frame. At the top of window extend the back plate 1/2" above the window flashing (if using flashings with an end dam then extend 1/2" past the top edge of the end dam) and fasten.

(Figure 18.3 a & b) (See **Fastening Info**).

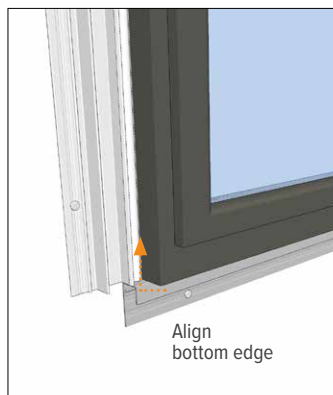

Figure 18.3 a

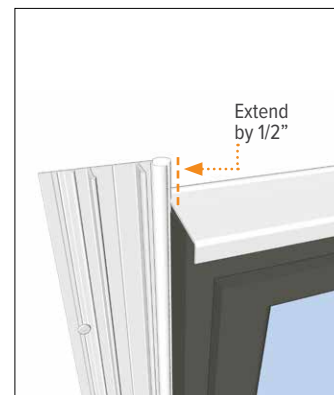

Figure 18.3 b

3. Apply a continuous bead of sealant to EZ.19 back plate caulking channel. (Figure 18.4).

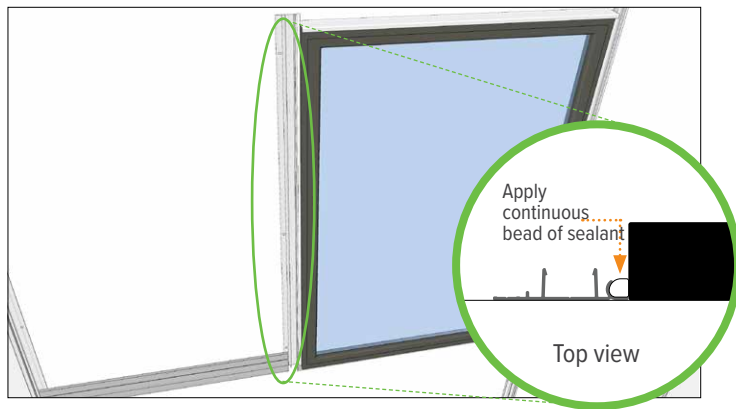

Figure 18.4



## Basic Panel Window Details (Cont.)

4. Below the bottom of the window align the center of the EZ.7 back plate with the center of the EZ.19 back plate leaving the EZ.7 back plate 6" down from the window sill and fasten. (Figure 19.1) (see **Fastening Info**).

**NOTE:** Keeping the EZ.7 back plate back 6" will allow the top cap to transition from the EZ.19 to the EZ.7 back plate.



Figure 19.1

5. At bottom of window apply an EZ.5 horizontal by lapping it over the EZ.19 nailing flange and leave a 1/16" gap from the EZ.Bump® and fasten. (Figure 19.2).

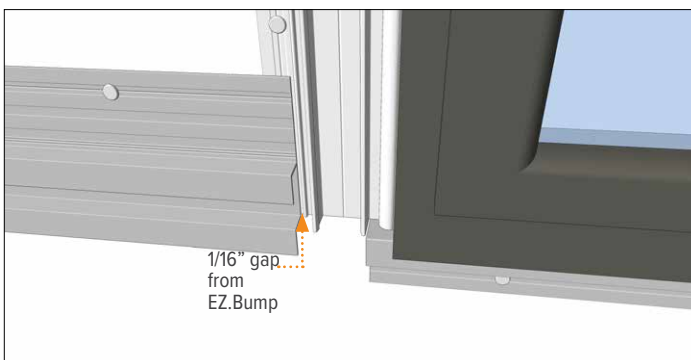

Figure 19.2

6. Cut an EZ.19 / EZ.7 top cap from the top edge of the panel at the top of the window (Figure 19.3 a) down to the outer edge of the horizontal trim that is below the window sill (Figure 19.3 b). The top cap should run from the top of the window down past the sill to the next horizontal course (Figure 19.3 c).

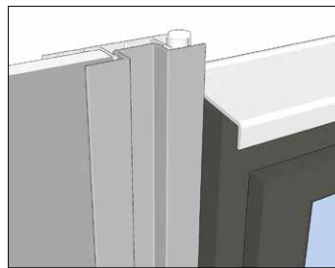

Figure 19.3 a

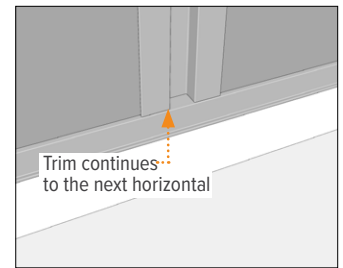

Figure 19.3 b

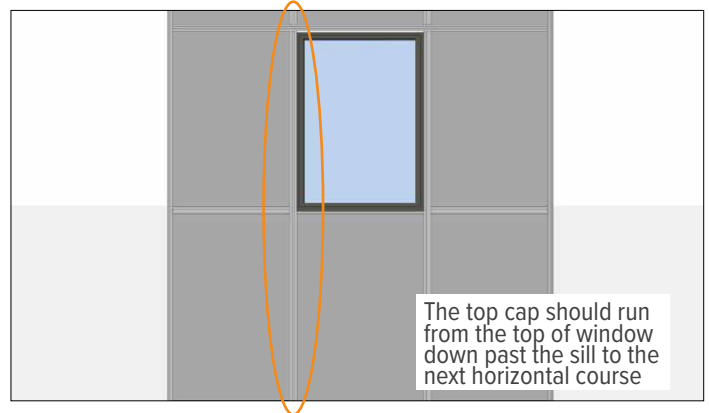

Figure 19.3 c

7. At the head of the window install an EZ.5 so that it laps over the EZ.19 and the panel. The EZ.5 should run continuous over the top of window. Continue the install from the EZ.5 using the general instructions. (Figure 19.4).

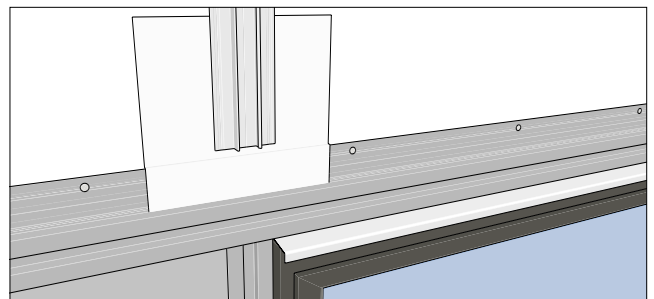
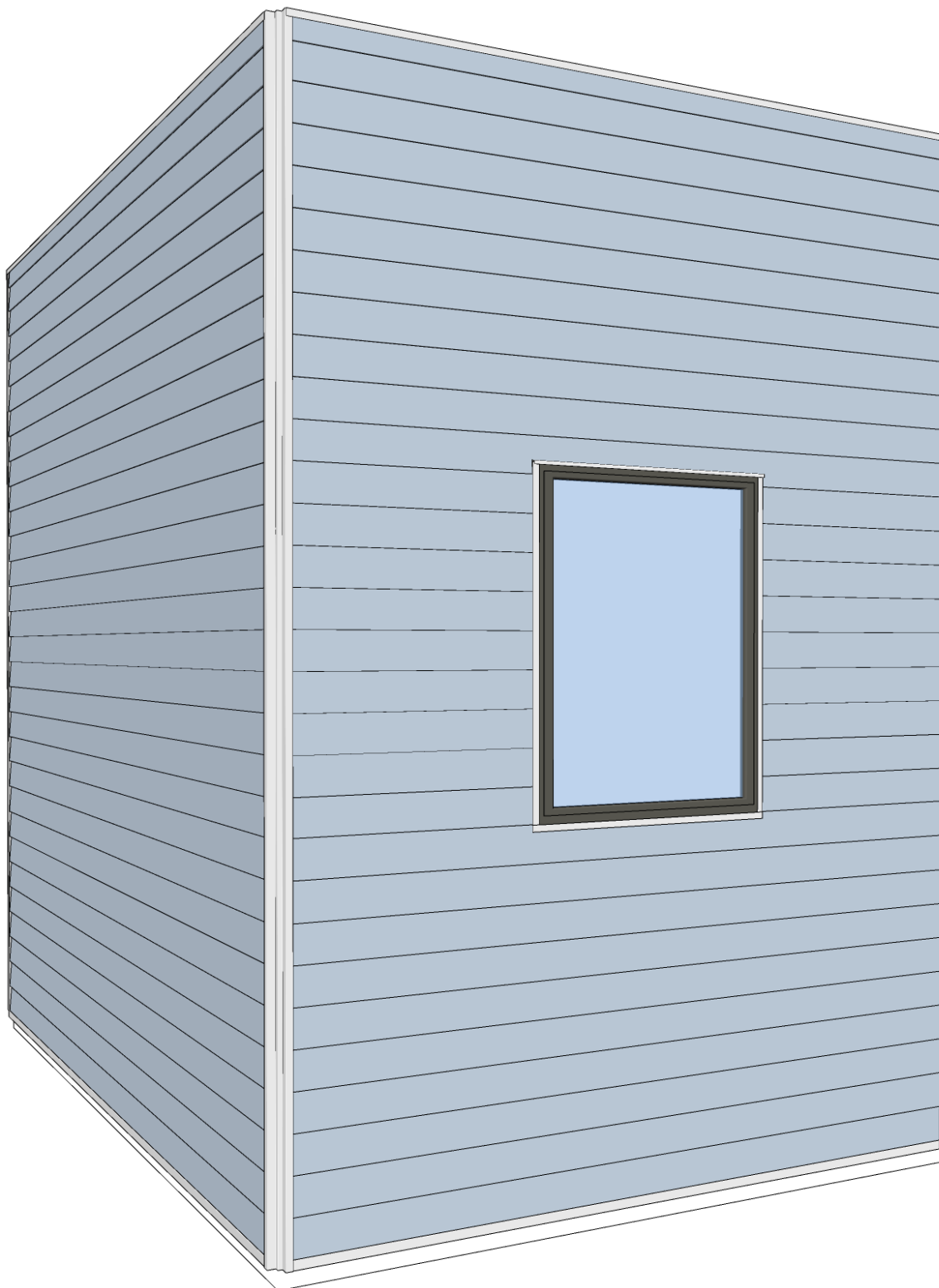

Figure 19.4



# General Lap Installation Process

## Completed Lap Installation



## General Lap Installation Process

1. Place the bottom of the EZ.31 outside corner at the cladding start point and fasten. (Figure 23.1) (see **Fastening Info**).

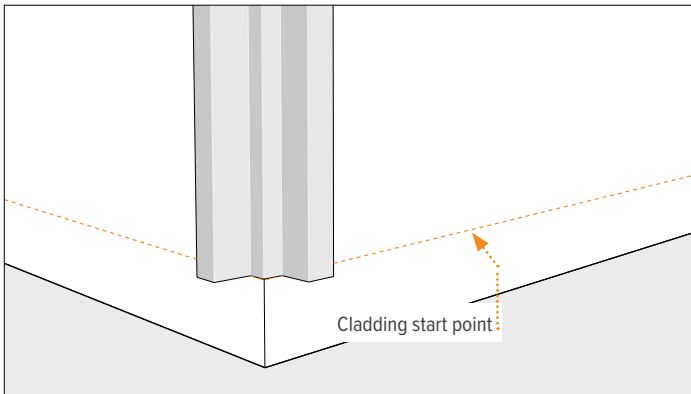

Figure 23.1

2. Place the EZ.48 starter trim over top of the nailing flange of the vertical outside corner, leaving a 1/16" gap from the EZ.Bump®. Align the bottom edge of the horizontal trim with the bottom of the vertical outside corner. Level and fasten. (Figure 23.2).

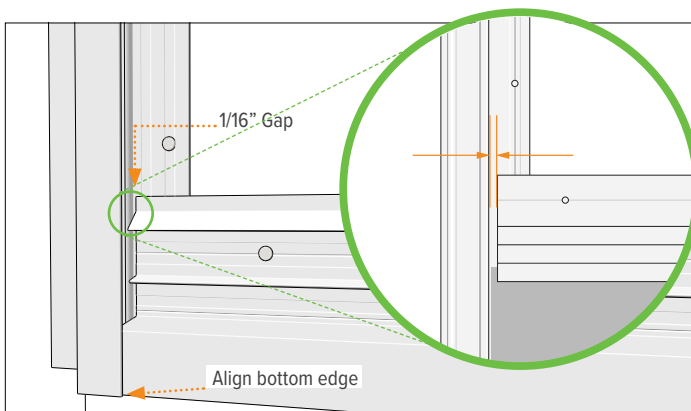

Figure 23.2

3. At the top of the wall apply an EZ.40 J trim and fasten in place. (Figure 23.3) (See **Fastening Info**).

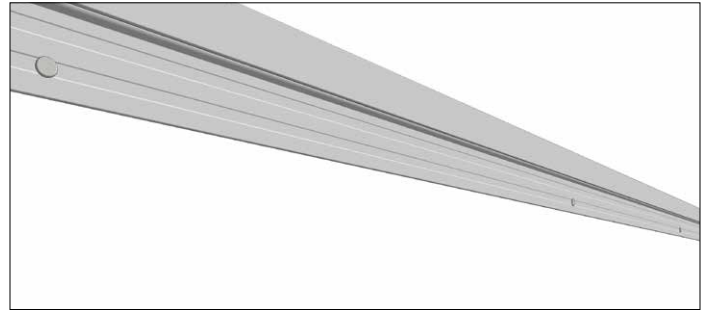

Figure 23.3

4. When an EZ.40 terminates into another trim, notch the end of the EZ.40 3" along the side and then across the nailing flange. Tuck the tab of the EZ.40 under the tab of the intersecting vertical trim. (Figure 23.4 a & b).

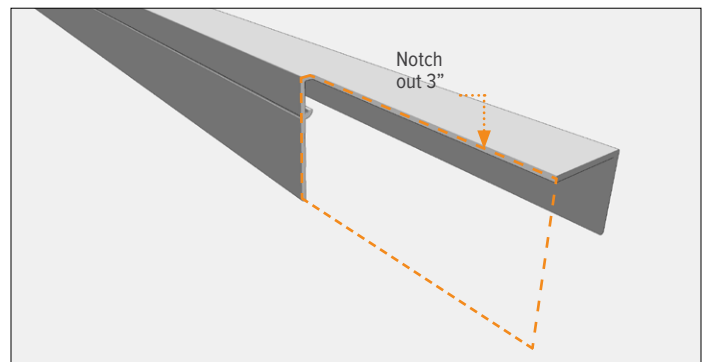

Figure 23.4 a

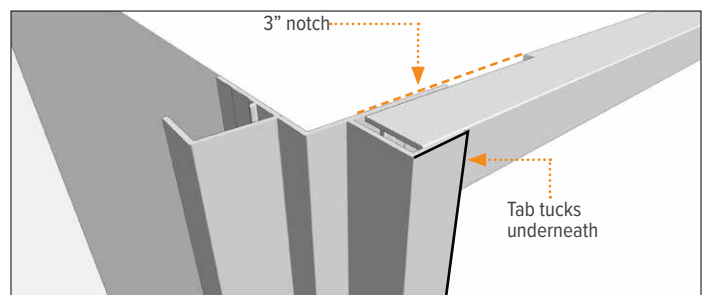

Figure 23.4 b

## Basic Lap Window Details

1. Extend EZ.40 J trim 3/4" past both sides of the window sill (Figure 24.1). Cut a notch into the edge of both sides of window sill trim flush to window frame.

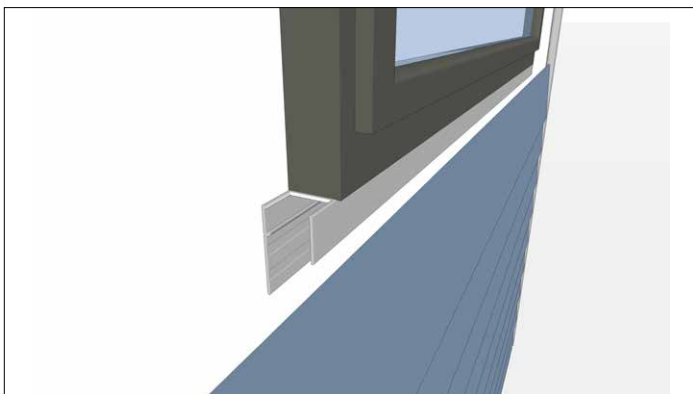

Figure 24.1

2. Install EZ.40 J trim along the jamb so that the bottom butts up to the sill J trim and aligns with the notch previously cut in the sill trim. Then cut and install a lap plank to fit into the sill and jamb trims. (Figure 24.2).

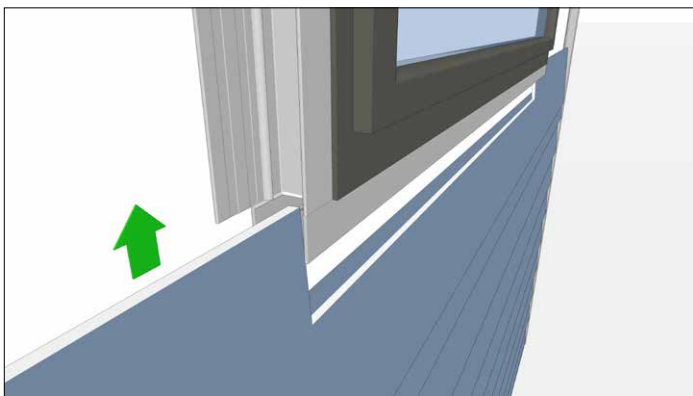

Figure 24.2



3. Extend EZ.40 J trim up past the edge of the window flashing 1/8" (Figure 24.3).

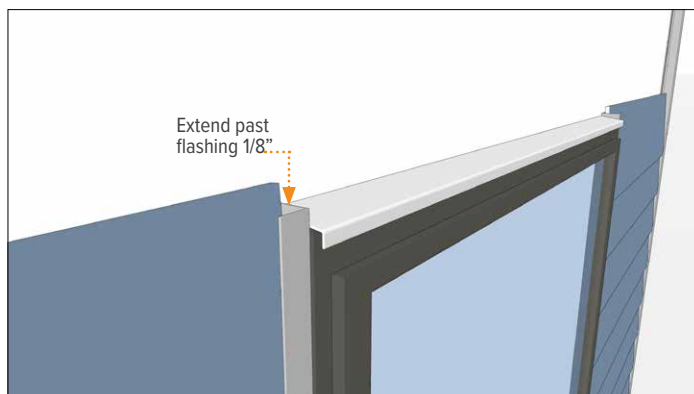

Figure 24.3

4. Cut lap to fit into EZ.40 J trim (Figure 24.4).

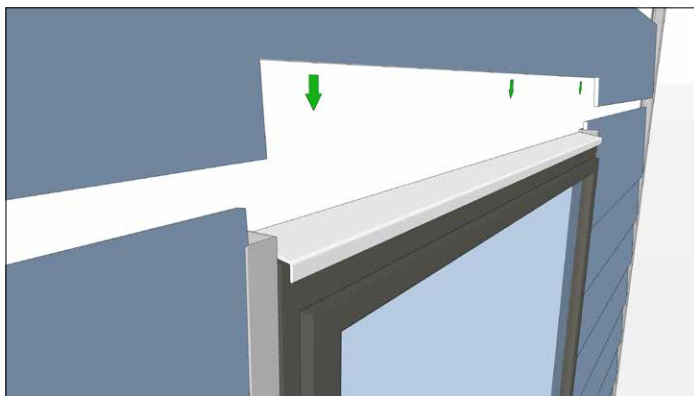

Figure 24.4



Figure 24.5



## FAQ

### What is the maximum building height to which EasyTrim Reveals® trim profiles can be fastened?

Please refer to your siding manufacturers technical documents for their maximum height limits.

### Can I paint EasyTrim Reveals® trim profiles on-site?

Yes. EasyTrim Reveals® offers a primed finish option for your on-site needs.

#### Notes:

1. Paint will not adhere to our anodized finishes.  
**\*\*If you would like to paint your EasyTrim Reveals® trims on-site, after installation, you must use our EasyTrim Reveals® primed materials.**
2. Once painted, the applicable warranty is that of the paint provider.

### What type of exterior paint is recommended when painting EasyTrim Reveals® primed trim profiles on site?

Use a high-quality 100% exterior grade acrylic latex paint when painting primed EasyTrim Reveals® trim profiles on site. This is the same paint recommended by the fiber cement manufacturers for use when painting primed fiber cement products as well, therefore both primed fiber cement and primed EasyTrim Reveals® are painted with the same paint formulation when painted on site. Various paint manufacturers offer high-quality 100% acrylic latex paint.

### How thick are EasyTrim Reveals® trims?

EasyTrim Reveals® trims are 15-gauge (1.4 mm or 0.055") thick, typically.

### What tool should I use on-site to cut EasyTrim Reveals® trim profiles?

EasyTrim Reveals® recommends using a miter saw with a non-ferrous metal cutting blade.

### Can EasyTrim Reveals® trim profiles be used with siding products other than fiber cement?

Yes. EasyTrim Reveals® trim profiles were originally designed to be an exterior product used with fiber cement; however, you can use it with many other siding types such as cedar and other natural wood products, metal panels, and more. Any siding product that fits within our profile depths may be used within the EasyTrim Reveals® system.

### What lengths are EasyTrim Reveals® trim profiles available in?

All of our profiles are ten foot (10') lengths.

### What color options are EasyTrim Reveals® trim profiles available in?

With our ColorMatch® paint program, EasyTrim Reveals® is able to provide our trim profiles in any color option imaginable (including your brand specific colors). Our standard finishes include:

- Clear anodized (silver matte finish).
- Black anodized.
- Primed finish.

Pre-finished anodized aluminum EasyTrim Reveals® trim profiles deliver the best value for your dollar – short- and long-term – because anodized aluminum is a very low maintenance finish.

## FAQ

### **What type of aluminum is used to make EasyTrim Reveals® trim profiles?**

All our extruded aluminum profiles are made out of 6063-T6 aluminum.

### **What is the back plate in the EasyTrim Reveals® system?**

All of the two piece EasyTrim Reveals® fiber cement trims that contain the patented EZ.Lock® engagement feature both a back plate and a top cap. The back plate is the part of the assembly that is fastened to the wall and features the engagement that receives and locks the top cap into place.

### **What is a top cap in the EasyTrim Reveals® system?**

All of the two piece EasyTrim Reveals® fiber cement trims that contain the patented EZ.Lock® engagement feature both a back plate and a top cap. The top cap is the part of the assembly that snaps into the wall-fastened back plate covering the ends of the installed panel and planks.

## Product Warranty

The EasyTrim Reveals® Aluminum Reveal Wall System 15-Year Limited Warranty is extended to original purchasers of EasyTrim Reveals® aluminum trim profiles.

This Warranty is for the benefit of the original property owner who purchased the product and is not transferable. EasyTrim Reveals® warrants that our Aluminum Reveal profiles, when installed properly shall be free of manufacturing defects in workmanship and materials and will not split, crack, peel, blister, flake, rust nor be subject to abnormal weathering. With proper substrate, EasyTrim Reveals® will not buckle or split.

If the aluminum reveal profiles fail to perform as warranted, EasyTrim Reveals® will provide, at its option, replacement parts or components to the dealer specified by the original purchaser at no cost. EasyTrim Reveals® will not be responsible for installation or labor costs.

### GENERAL CONDITIONS & EXCLUSIONS

The EasyTrim Reveals® Warranty is not transferable and is subject to the general conditions and exclusions. There are certain conditions or applications over which EasyTrim Reveals® has no control. The EasyTrim Reveals® Warranty does not cover defects or problems as a result of such conditions or applications.

What is not covered:

- Damage caused by improper installation, use, application or maintenance.
- Damage to the finished metal caused by handling, shipping, processing; storage, installation and/or improper cleaning.
- Damage from contact with harmful chemicals, fumes, or vapors.
- Normal weathering, chalking, fading, atmospheric pollutants or mildew build-up.
- Damage from settlement, shrinkage, or distortion of the structure.
- Pre-finished or field applied coatings.
- Acts of God, fire and casualty; and installation or labor costs.

The limited warranties set forth are the only warranties (whether written or oral) applicable to EasyTrim Reveals® wall system profiles.

EasyTrim Reveals® MAKES NO OTHER WARRANTIES, EXPRESS OR IMPLIED AND MAKES NO IMPLIED WARRANTIES OF MERCHANTABILITY OR FITNESS FOR A PARTICULAR PURPOSE. THE REMEDIES STATED WITHIN ARE YOUR SOLE AND EXCLUSIVE REMEDY AND WILL NOT BE RESPONSIBLE FOR INCIDENTAL OR CONSEQUENTIAL DAMAGES RELATING TO YOUR PURCHASE OR USE OF EasyTrim REVEALS PRODUCTS. EasyTrim Reveals® INC. LIABILITY IN ALL INSTANCES WILL BE LIMITED TO REPLACEMENT OF MATERIAL BASED ON PURCHASE DATE AND WARRANTY CLAIM DATE.

This warranty is applicable in Canada, the United States and Australia. Some states do not allow for the exclusion of incidental or consequential damages, so the above limitations or exclusions may not apply to you. This warranty gives you specific legal rights and you may also have other rights, which vary from state to state, and from country to country.

### HOW TO GET HELP IF YOU HAVE A WARRANTY CLAIM

To obtain help with a warranty claim, contact the dealer, distributor or building products supplier where the EasyTrim Reveals® were purchased originally. If, after thirty (30) days you have received no response to your concerns, then contact EasyTrim Reveals® Inc. via email sending your email to [warranty@easytrimreveals.com](mailto:warranty@easytrimreveals.com).

Please include the following documentation:

- Identify the EasyTrim Reveals® wall system profile(s), date and place of purchase, and purchase price (proof of purchase required).
- Describe the problem (photographs are required).
- Describe any action you have taken, or those persons contacted to correct the problem.
- Give your name, phone number and address where the product can be inspected.

1-877-973-8746 | [warranty@easytrimreveals.com](mailto:warranty@easytrimreveals.com)



Contact The Installation  
Support Team



Connect with a  
representative to help  
get your project started  
today!

